

Port House Antwerpen, Zaha Hadid Architects, Schüco Systems

Aluminium in Construction

ASI AGM

Montreal, 04.04.2017, Schüco International KG, Rolf Brunkhorst

SCHÜCO

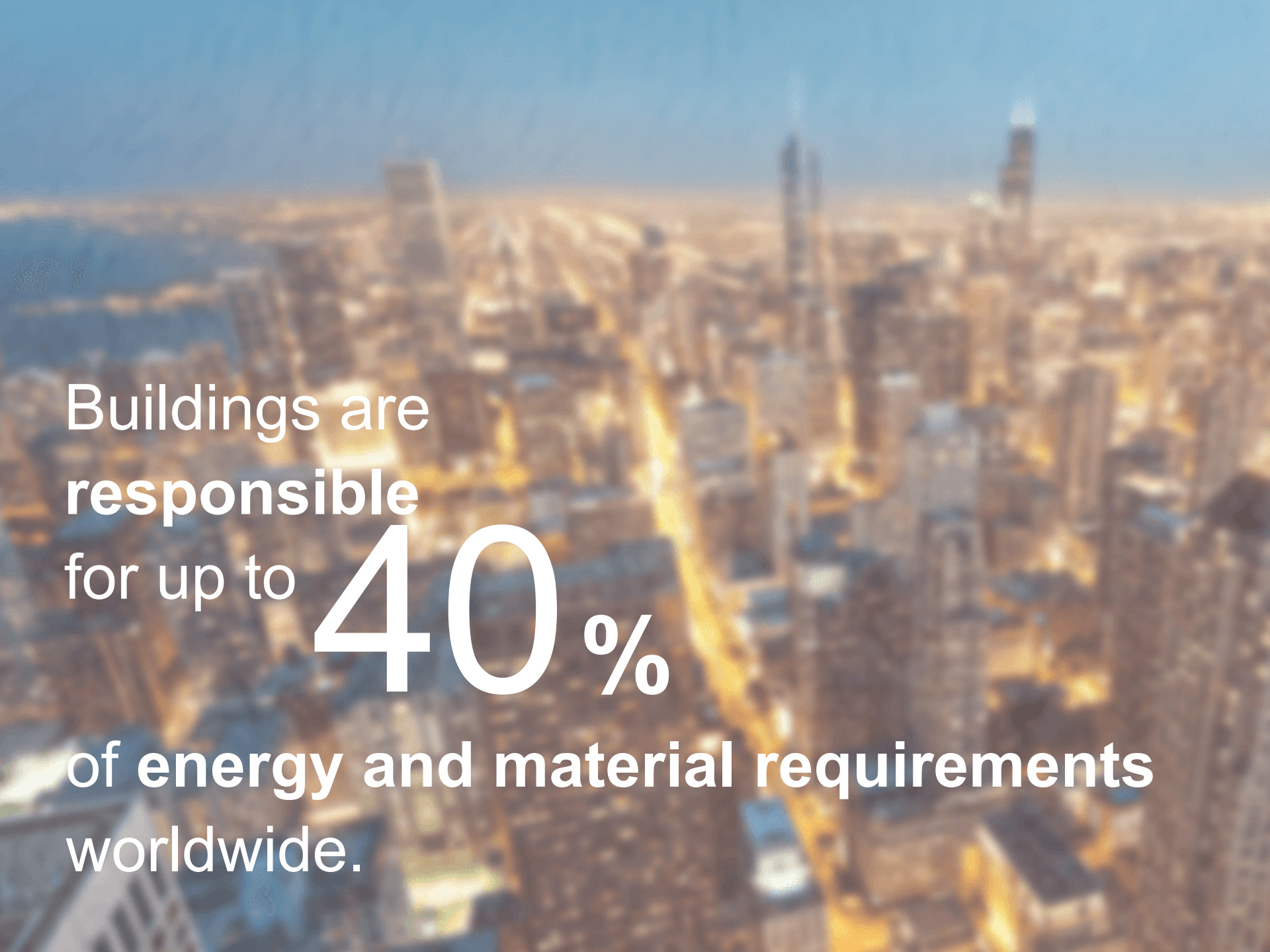
An aerial photograph of a city skyline at sunset. The sky is a deep blue, and the city is bathed in the warm, golden light of the setting sun. Numerous skyscrapers and buildings are visible, with some reflecting the sunlight. The overall scene is a dense urban landscape.

Buildings are
responsible
for up to **40%**
of **energy and material requirements**
worldwide.

A modern, white, curved building with large glass windows and balconies, set against a clear blue sky. In the foreground, a paved walkway leads towards the building, and a small group of people is walking. A green lawn is visible on the left side of the frame.

Our aim:

Buildings, that are

100%

comfortable, secure
and energy efficient

with high material effectiveness
and sustainability.

At home in East Westphalia

Company headquarters, Bielefeld



With a workforce of around
2,000 employees,
Schüco International KG is one of the
biggest employers in the strong
economic region of East Westphalia.

**4,800 employees
worldwide.**

Roots in Bielefeld, presence worldwide

International market presence

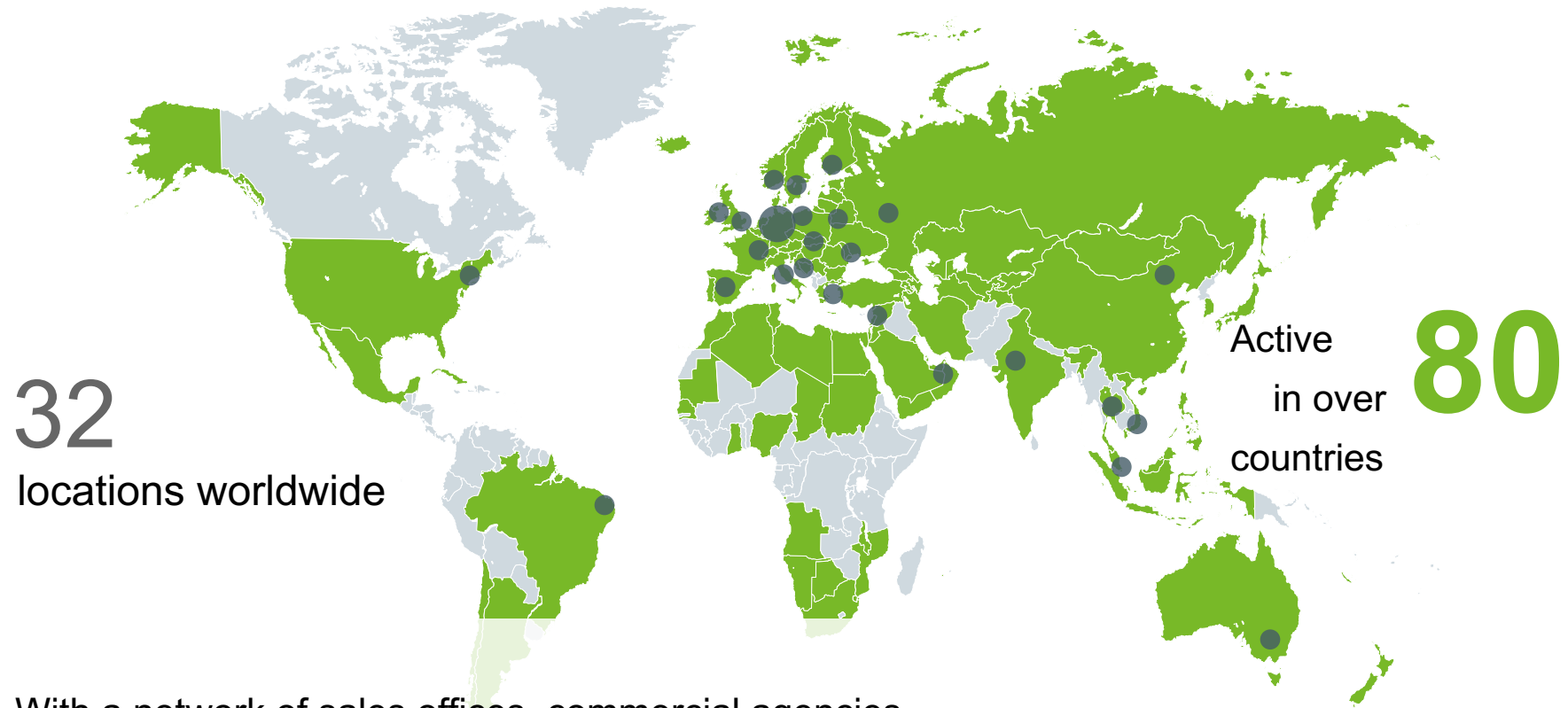

With a network of sales offices, commercial agencies, subsidiaries and licence partners, **Schüco** is represented worldwide.



SCHÜCO

Living and working for Schüco

Product range for residential projects

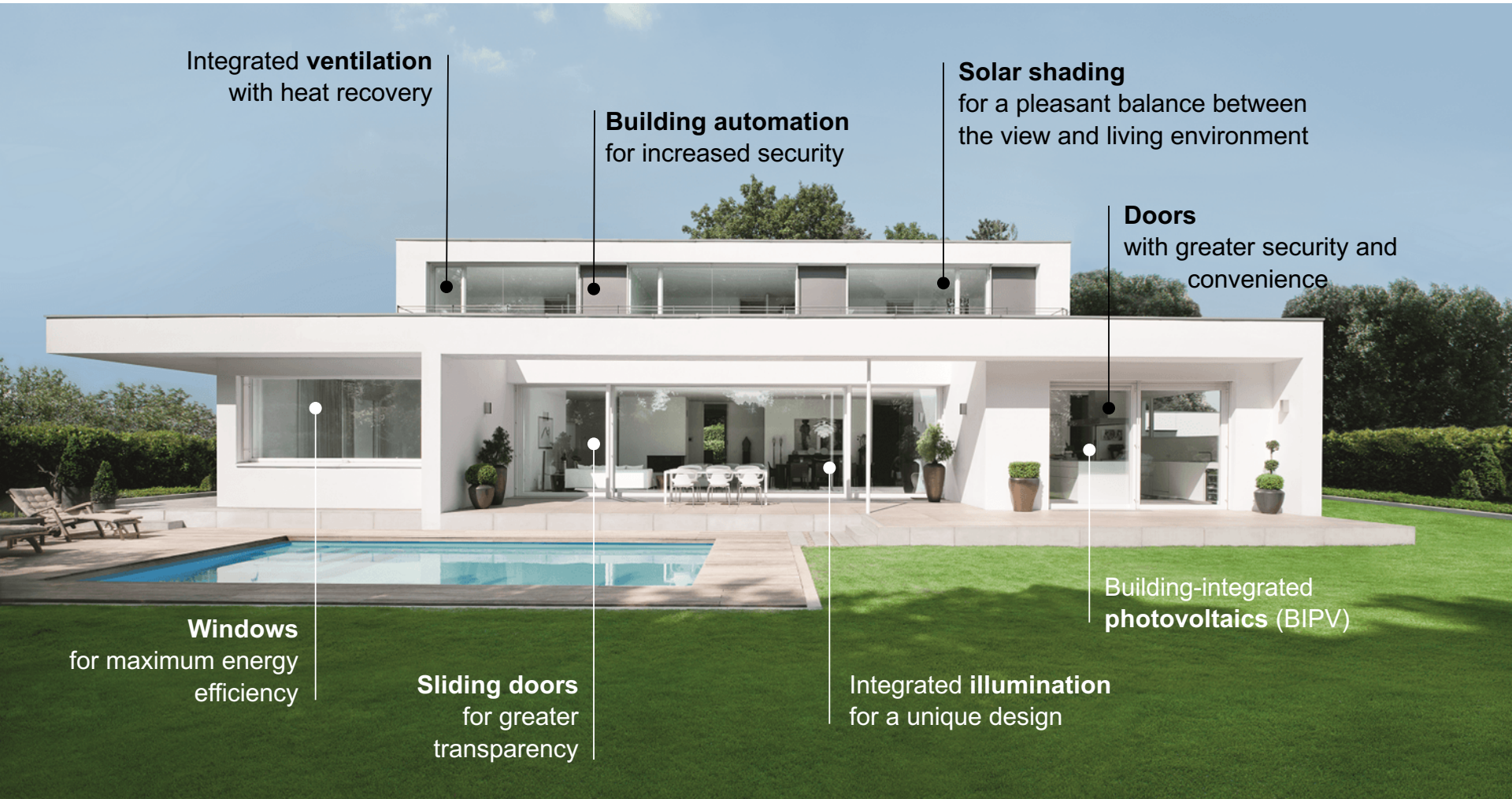

Working environment from Schüco

Product range for commercial projects

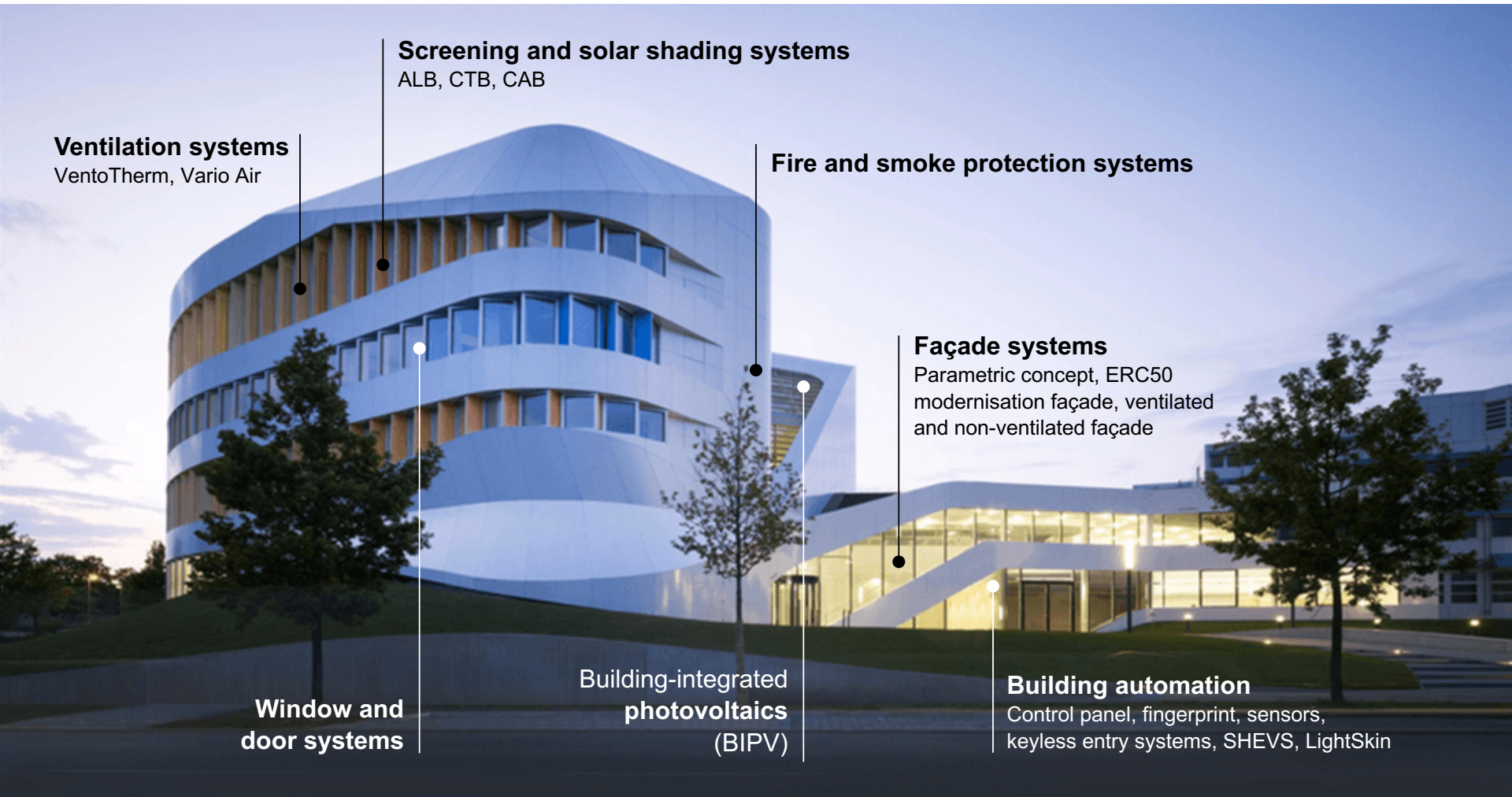



The basis of our innovations

Schüco business divisions



Aluminium

Aluminium windows, doors and façades for luxury residential and commercial projects.



PVC-U

PVC-U windows and doors for family homes and apartment buildings.

An overview of the most important certification systems

breeam



	BREEAM	LEED	DGNB
Description	Building Research Establishment Environmental Assessment Method	Leadership in Energy & Environmental Design	German quality seal for sustainable construction
First introduced	1990	1999	2008
Funding	Private: BRE Certification Ltd (subsidiary of BRE Trust)	Private: US Green Building Council (USGBC) - Not-for-profit organisation	Private: German Sustainable Building Council (DGNB) [Development first together with BMVBS]
Website	www.breeam.org	www.usgbc.org	www.dgnb.de
No. of certificates	~ 250,000	~ 30,500 ... > 35,500 registered projects	~ 1250 certificates or preliminary certificates
Application	Voluntary		
Aim	To make building quality measurable and comparable		

... 95 % residential construction projects
... > 1,000,000 registered



... Differences in evaluation methods and declaration



ZVE, Stuttgart: DGNB Platin zertifiziert



Statoil Hauptsitz, Norwegen: BREEAM Outstanding zertifiziert



Siemens City, Wien: LEED Platin zertifiziert

Cradle to Cradle®

The method of closed cycle waste management

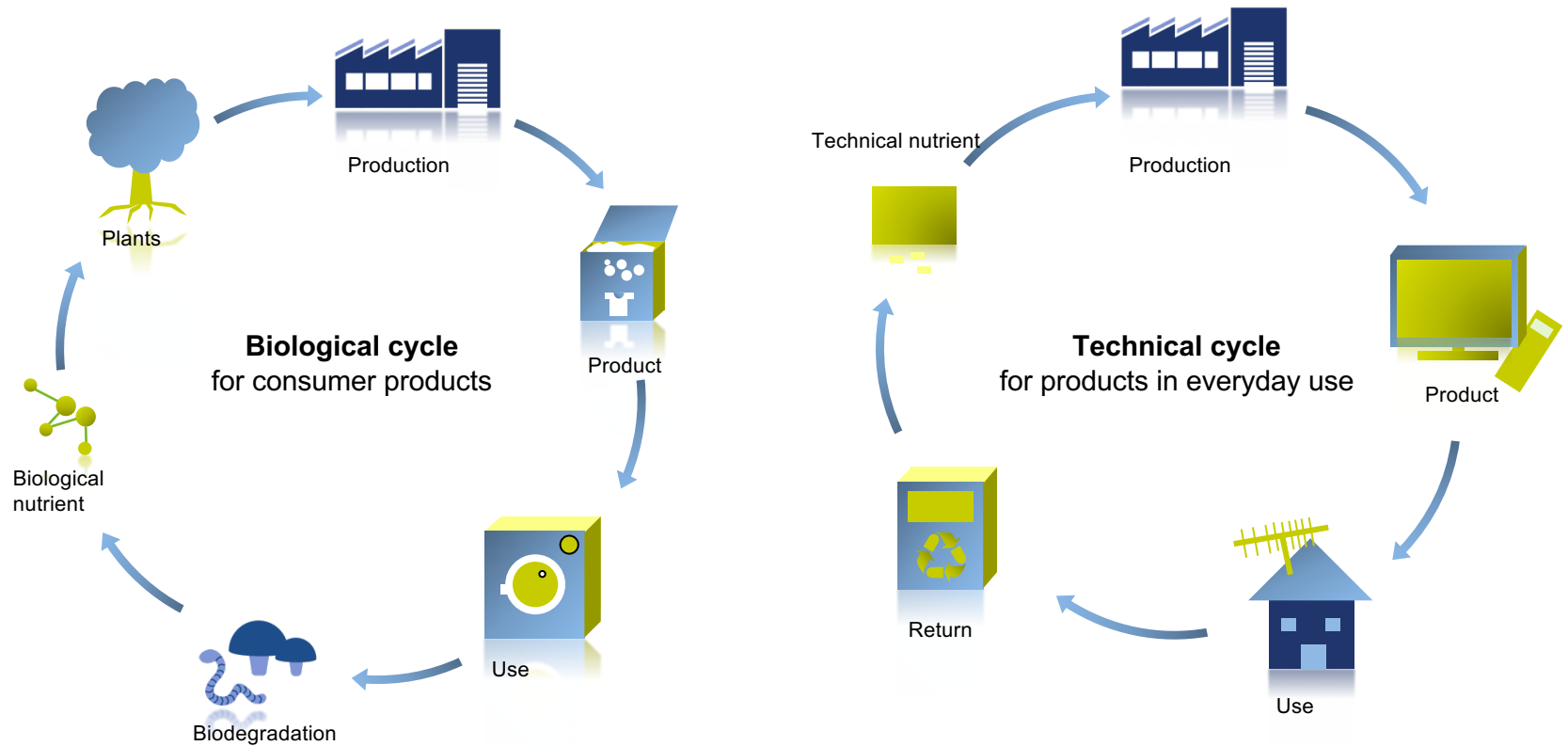

Source: © EPEA GmbH 2009, Drees&Sommer

Dismantling of window frames, which are then...



... to be processed into Shredder and remelted



Aluminium recycling in window and façade construction

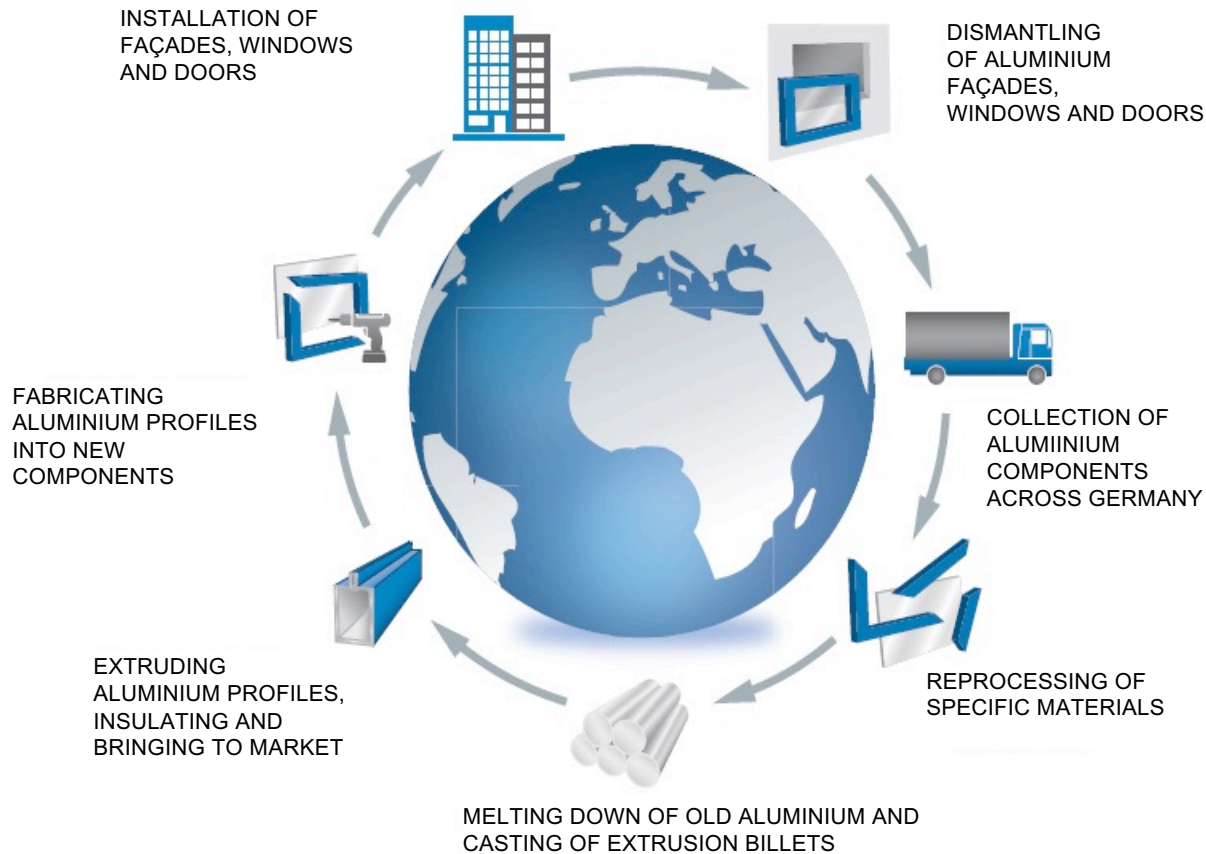

<http://www.a-u-f.com/>

The current sphere of influence ...

A beginning development:

Building certification systems and
public and private tenders
require
a certified sustainable supply chain

Semi-fabrication

Product manufacture and use

Recycling



Material stewardship

Images © Rio Tinto and Novelis

Competitive materials



...priority issues for ASI standards to close the gap

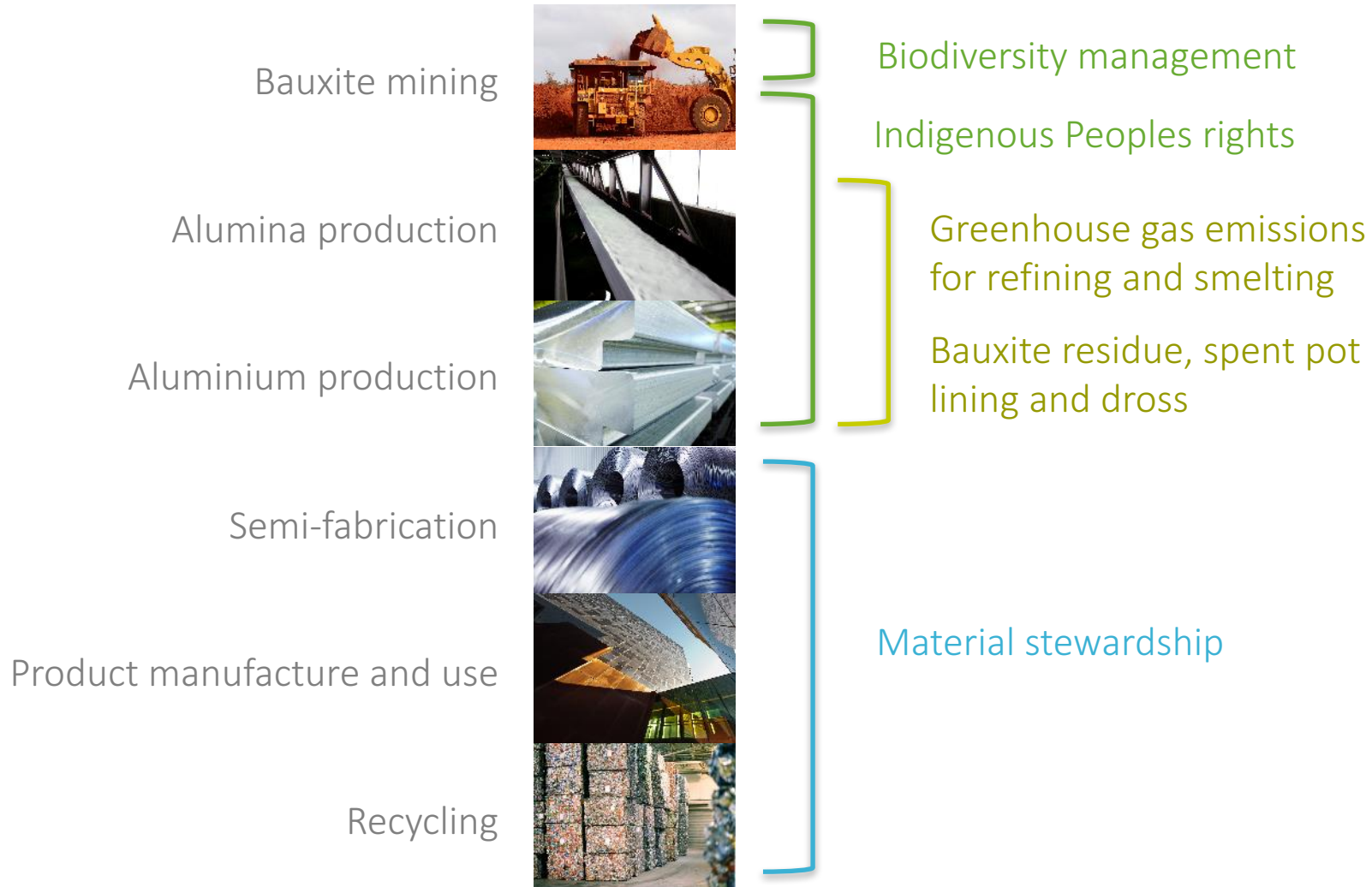

Images © Rio Tinto and Novelis

For ASI certified aluminum the construction sector can ...

- develop an increasing demand in building industry and property sector
- provide sustainable impulses to government and administration
- create a broad sustainable reputation
- support the ASI approach as best excellence for other metal organizations

... if supply is equal or overtakes the demand.

The building sector needs one sort of aluminum: the sustainable one

- Differentiation in two sorts would lead to obscure complexity
- Two sorts: sustainable / not sustainable will not be accepted
- Up to securing necessary supply the market will act very carefully
- That is only OK for piloting

A strong commitment between upstream and downstream industry is necessary for a successful movement.

Schüco 360° sustainability approach

Conserving resources and reducing CO₂

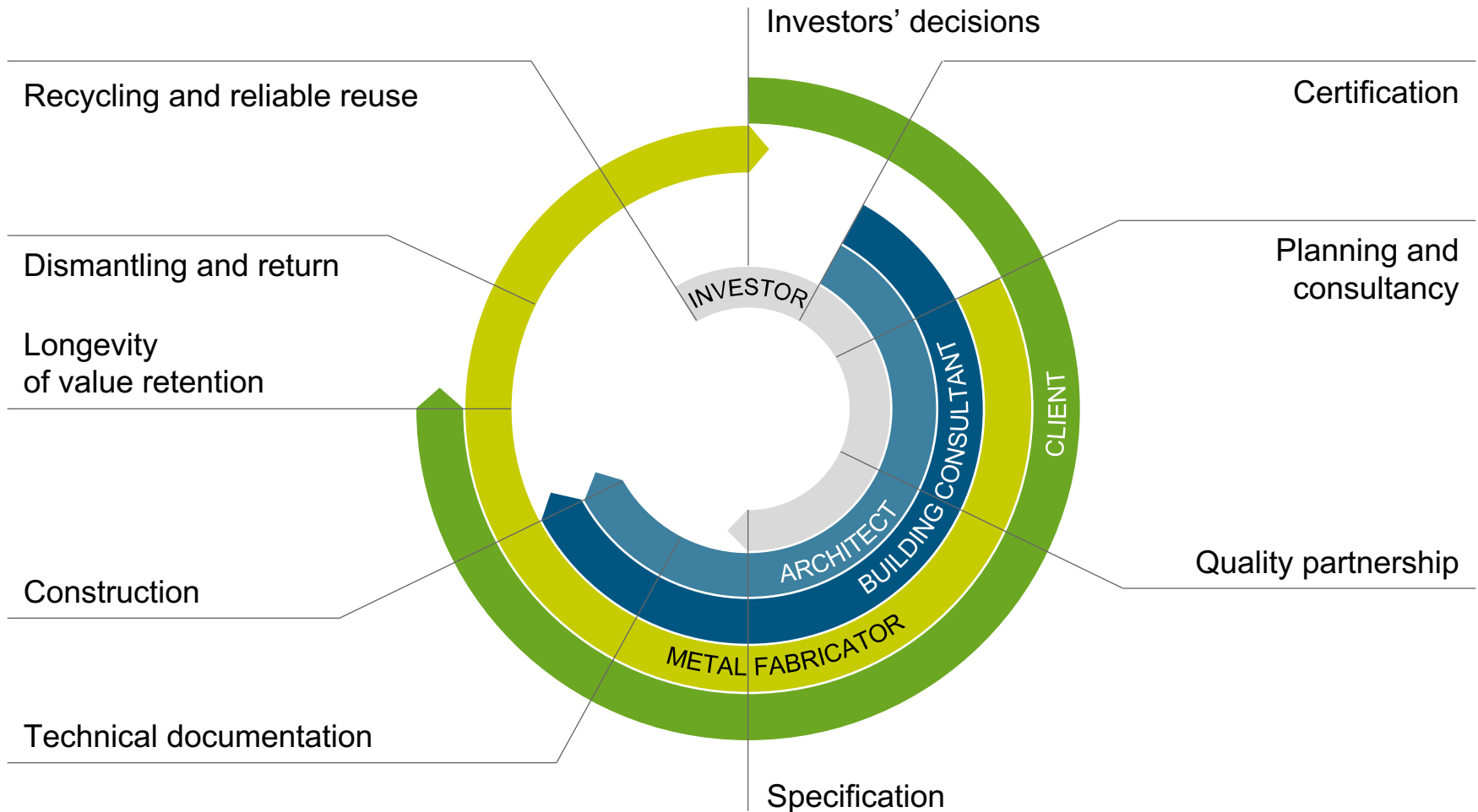

At Schüco, we achieve
outstanding results in
everything we do.

Aluminium Stewardship Initiative

A multi-stakeholder approach to responsible sourcing

Thank you!

Rolf Brunkhorst
Company Coordination
Head of Sustainability

Schüco International KG
Karolinenstraße 1-15
33609 Bielefeld
Germany
Tel. +49 521 783-9213
Mobil +49 151 17451565
rbrunkhorst@schueco.com
www.schueco.com



SCHÜCO

SCHÜCO